

RAD SMART SOCKETS 33mm

Part Number: **20879**



LIGHTER **FASTER** STRONGER

RAD Smart Sockets™ use RAD Torque's transducer technology combined with a socket to measure torque applied to the bolt. Its a perfect audit tool for inspecting bolted joints and a master calibration for torque tools.

SPECIFICATIONS

Torque Ranges: 150 ft. lbs. – 1500 ft. lbs.
Weight: 2.65 lbs.
Square Drive: 0.75"
Repeatability: +/-1
Accuracy: +/-1%

DIMENSIONS

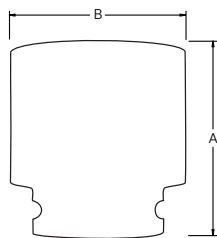

DIMENSION A	DIMENSION B
3.94"	2.83"



Non
Impacting



Safe &
Reliable



Class 1 Division
2 Group A, B,
C, D T4



Accredited
ISO/IEC 17025

Included Storage Case

Weatherproof. Comes with Plug & USB cord.



Bluetooth connectivity to
your smart phone or tablet

RADTORQUE.COM

NEW WORLD TECHNOLOGIES INC

30580 PROGRESSIVE WAY | ABBOTSFORD, BC V2T 6Z2 | CANADA | **1.800.983.0044**